



LOGAN UNIVERSITY

SYMPOSIUM 2023

LEARN. LEAD. LIVE.



**APRIL 13-16
2023**

**ST. LOUIS
UNION
STATION**

**2023 EXHIBITOR
& SPONSORSHIP
PACKET**

	Exhibitor	Bronze	Silver	Gold	Platinum
Investment	\$1,000	\$2,000	\$4,500	\$7,500	\$10,000
Booth Space: 1 skirted table (6'x30"), 2 chairs, 1 wastebasket, booth identification sign, and 2 representative name badges	10x10	10x10	10x10	10x20	10x20
Recognition in Annual Report of Giving inside Tower Magazine	✓	✓	✓	✓	✓
Vendor recognition in event app	✓	✓	✓	✓	✓
Invitation to Benefactor Dinner (Saturday night)	2 Guests	2 Guests	4 Guests	4 Guests	6 Guests
Sponsor sign displayed at your booth		✓	✓	✓	✓
Sponsor recognition on event monitors		✓	✓	✓	✓
Sponsor recognition on website		✓	✓	✓	✓
Sponsor recognition & information in event app		✓	✓	✓	✓
Raffle entry for free exhibitor booth for 2024 Symposium		1 Ticket	2 Tickets	4 Tickets	6 Tickets
Ad posted in event app			✓	✓	✓
Social media mention			1 Mention	2 Mentions	4 Mentions
Post-event email thanking our attendees for joining us at the event - to include sponsor logo and contact information			✓	✓	✓
Opportunity to include item for raffle during breaks. Sponsor mentioned with 15 second elevator pitch announced by Symposium employee			✓	✓	✓
Logo on 24x36 directional signage				✓	✓
Company provided 60-second commercial to play in the minutes prior to the opening sessions each morning				✓	✓
Company logo with website link to be included in the attendee registration confirmation email				✓	✓
Mentioned in morning welcome				✓	✓
Logo on main stage slides				✓	✓
Access to VIP & Alumni Lounge				✓	✓
Delivery of personal message during Friday's morning welcome (3 minutes)					✓
VIP Seating for 6 Guests in continuing education hall					✓
Company logo on attendee gift					✓
Priority booth placement					✓

SIGNAGE ADD-ON'S

Location #	Opportunity	Location	Qty	Size	Cost
1	Graphics on Main Hotel Elevators	1st Floor	3	41.75" x 83.75"	\$500
1	Graphics on Main Hotel Elevators	2nd Floor	3	41.75" x 83.75"	\$500
2a	Graphics on Stairs Landings	Hotel to Vendor & Ballroom	1	100" x 120"	\$1,600
2b	Graphics on Stairs Landings	Hotel to Vendor & Ballroom	1	100" x 120"	\$1,600
3	Midway Overhang	Vendor Hall	1	Max 96" x 200'	\$20 per/ft2
4	Midway Rafter Signs - Double Sided	Vendor Hall	3	120" x 48"	\$1,800
4	Midway Rafter Signs - Double Sided	Vendor Hall	3	96" x 48"	\$1,400
5	Build in Registration - C	Ballroom Entry Corridor	1	24.5" x 47"	\$250
5	Build in Registration - D	Ballroom Entry Corridor	3	24" x 47"	\$250
6	Graphics on Ballroom Elevator	CE Ballroom	1	41.75" x 83.75"	\$600
7	Wall Space between Registration & Ballroom	Between Registration & Ballroom	1	100.75" x 107.5"	\$1,500
8	Wall Space from CE to Vendor Hall	Between Ballroom & Registration	1	155" x 85"	\$2,000
9	Graphics on Ballroom Lobby Window	Ballroom Entry	6	58" x 75.75"	\$650

Location numbers correspond with the numbers and areas on the following pages.

ADDITIONAL ADD-ON'S

Opportunities	Qty	Cost
Logo on Symposium pocket schedule to be given to every attendee at registration	1	\$1,500
Logo on event lanyard to be given to every attendee and vendor at registration	1	\$2,000
Break Sponsor	4	\$2,500
Logo on Hotel Key Card - Specially branded hotel key cards with your companies logo	1	\$5,000
Alumni Lounge Sponsor	1	\$7,500
Mix & Mingle Sponsor	1	\$10,000
Scholarship Luncheon Sponsor	1	\$10,000

Secure your sponsorship by March 10, 2023 to guarantee access to sponsor benefits! After that date, every effort will be made to honor sponsorship levels, but time-sensitive benefits cannot be guaranteed. Contact Dawn Brokaw at dawn.brokaw@logan.edu or (636) 230-1961.

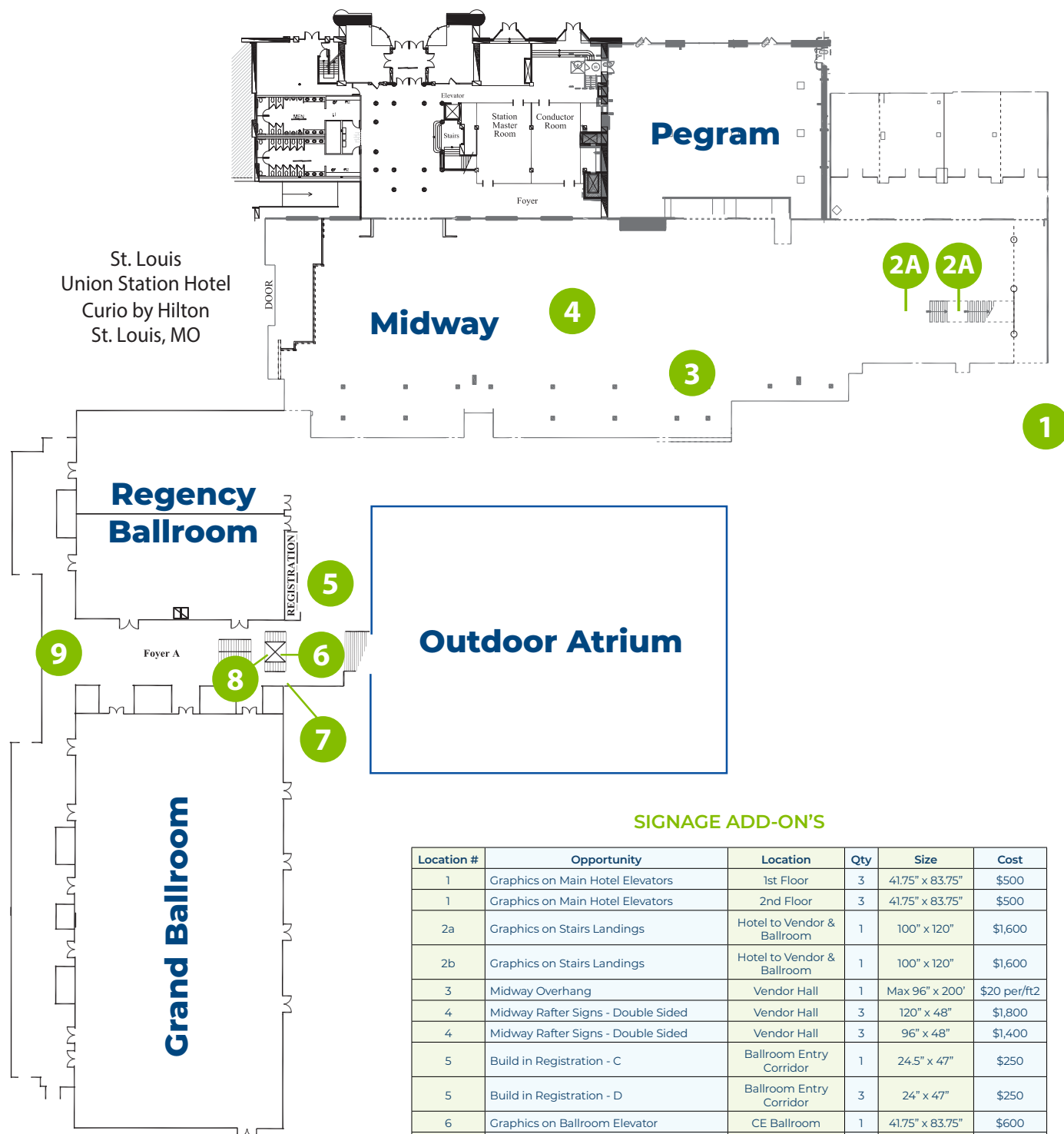

SIGNAGE ADD-ON'S

Location #	Opportunity	Location	Qty	Size	Cost
1	Graphics on Main Hotel Elevators	1st Floor	3	41.75" x 83.75"	\$500
1	Graphics on Main Hotel Elevators	2nd Floor	3	41.75" x 83.75"	\$500
2a	Graphics on Stairs Landings	Hotel to Vendor & Ballroom	1	100" x 120"	\$1,600
2b	Graphics on Stairs Landings	Hotel to Vendor & Ballroom	1	100" x 120"	\$1,600
3	Midway Overhang	Vendor Hall	1	Max 96" x 200'	\$20 per/ft2
4	Midway Rafter Signs - Double Sided	Vendor Hall	3	120" x 48"	\$1,800
4	Midway Rafter Signs - Double Sided	Vendor Hall	3	96" x 48"	\$1,400
5	Build in Registration - C	Ballroom Entry Corridor	1	24.5" x 47"	\$250
5	Build in Registration - D	Ballroom Entry Corridor	3	24" x 47"	\$250
6	Graphics on Ballroom Elevator	CE Ballroom	1	41.75" x 83.75"	\$600
7	Wall Space between Registration & Ballroom	Between Registration & Ballroom	1	100.75" x 107.5"	\$1,500
8	Wall Space from CE to Vendor Hall	Between Ballroom & Registration	1	155" x 85"	\$2,000
9	Graphics on Ballroom Lobby Window	Ballroom Entry	6	58" x 75.75"	\$650

Location numbers correspond with the numbers and areas on the following pages.



Main Elevators

Outside: 41.75" x 83.75"

\$500 Installed

Stairs: Hotel Reg to Midway

1ST Landing (A): 100" x 120"

\$1,600 Installed

2ND Landing (B): 100" x 120"

\$1,600 Installed

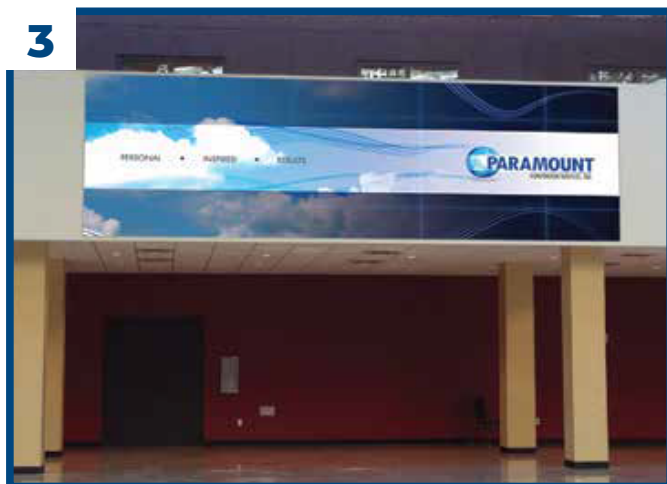

Midway Overhang

Maximum Length: 200'

Maximum Height: 96"

\$20 per sq ft Installed

Midway Rafter Sign

(Double Sided) A: 120" x 48"

\$1,800

(Double Sided) B: 96" x 48"

\$1,400



4



5

Built in Registration

C: 24.5" x 47"

\$250 Installed

D: 24" x 47"

\$250 Installed

Elevator to Ballroom

Outside: 44" x 84.5"

\$600 Installed



6

7



Wall Next to Stand Alone Reg

100.75" x 107.5"

\$1,500 Installed

Ballroom Elevator Backside

155" x 85"

\$2,000 Installed

8



9



Lobby Windows – End of Ballroom

B: 58" x 75.75"

\$650 ea Installed

April 14-15, 2023
 St. Louis Union Station Hotel
 A Curio Hotel Collection by Hilton Midway

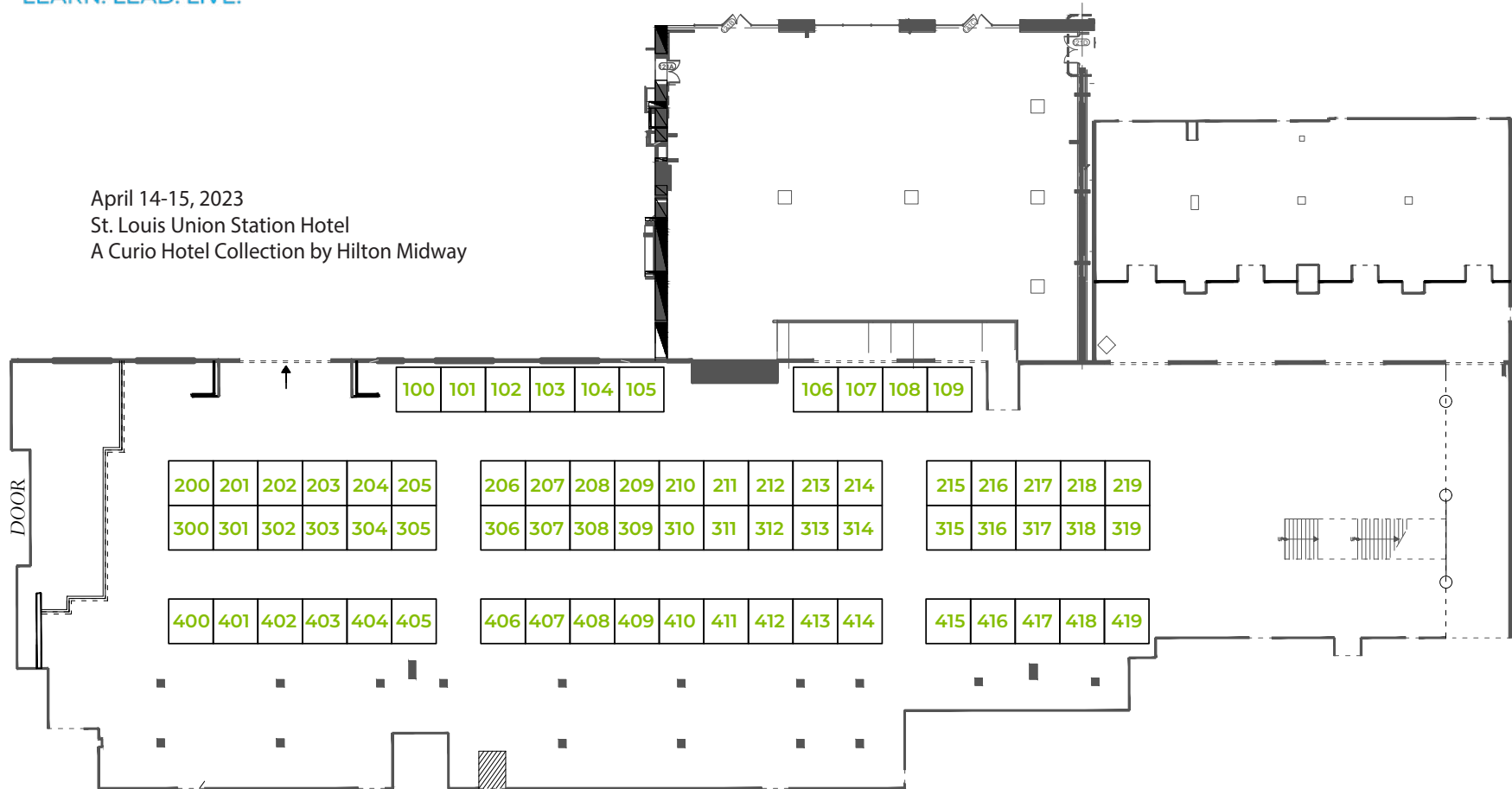

Booth Sizes:

Exhibitor	10' x 10'
Bronze	10' x 10'
Silver	10' x 10'
Gold	10' x 20'
Platinum	10' x 20' (end caps & corners)

Requested Booth Selection(s):

Gold & Platinum Sponsors, please select two (2) joining spaces.
 Preferences will be assigned in order based on sponsorship level.

Preference #1 _____

Preference #2 _____

Preference #3 _____

All exhibitor booths include: 1 skirted table (6'x30"), 2 chairs, 1 wastebasket, booth identification sign, and 2 vendor name badges.

Secure your sponsorship by March 10, 2023 to guarantee access to sponsor benefits! After that date, every effort will be made to honor sponsorship levels, but time-sensitive benefits cannot be guaranteed. Contact Dawn Brokaw at dawn.brokaw@logan.edu or (636) 230-1961.

SPONSORSHIP FORM

Complete this form and email to dawn.brokaw@logan.edu.

PRIMARY CONTACT INFORMATION

Primary Contact Name: _____ Title: _____

Company Name: _____

Address: _____

Industry / Product: _____

City: _____ State: _____ Zip: _____

Phone: _____ Email: _____

EXHIBITOR BADGES

The primary contact will receive an email from Logan University Office of Continuing Education with exhibitor registration instructions once the application is processed and booth space is assigned.

EXHIBITOR OR SPONSORSHIP SELECTION

- ☐ Platinum/ \$10,000
- ☐ Gold / \$7,500
- ☐ Silver/ \$4,500
- ☐ Bronze / \$2,000
- ☐ Exhibitor / \$1,000

SIGNAGE ADD-ON'S

Opportunity: _____

Location: _____ Qty: _____

Cost: _____

ADDITIONAL OPPORTUNITIES

- ☐ Logo on tear off schedule / \$1,500
- ☐ Logo on event lanyard / \$1,500
- ☐ Break Sponsor / \$2,500
- ☐ Logo on Hotel Key Card / \$5,000
- ☐ Alumni Lounge Sponsor / \$7,500
- ☐ Mix & Mingle Sponsor / \$10,000
- ☐ Scholarship Luncheon Sponsor / \$10,000

PAYMENT INFORMATION

Payment enclosed / Make check payable to Logan University.

Credit card, I authorize Logan University to charge \$ _____ to my

☐ VISA ☐ Mastercard ☐ American Express ☐ Discover

Card Number: _____

Expiration Date: _____ CVV: _____

Name on Card: _____

Signature: _____ Date: _____

Billing Address: _____

City: _____ State: _____ Zip code: _____

EMAIL: Dawn.Brokaw@logan.edu

MAIL to Attn: Logan University 1851 Schoettler Road, Chesterfield, MO 63017

QUESTIONS? Call 636.230.1961

EXHIBITOR BOOTH INFORMATION

Exhibitor Itinerary

St. Louis Union Station
stlouisunionstation.com/

Thursday, April 13, 2023

Booth Setup 12:00 pm – 5:00 pm

Friday, April 14, 2023

Expo Hall Open 7:00 am – 5:00 pm
 (option to stay open 6pm-8pm)

Saturday, April 15, 2023

Expo Hall Open 7:00 am – 4:00 pm
 Exhibitor Break Down and Load Out 4:00 pm – 6:00 pm Saturday or Sunday Morning

Exhibitors will be able to interface with attendees during morning breaks, afternoon breaks, and at social events. Two social events are scheduled one for Thursday, April 13, on Logan's Campus 5-7pm and another for Friday, April 14, at St. Louis Union Station 6-8pm. Logan University and St. Louis Union Station are not responsible for any lost, stolen or damaged items.

Payment Information

Call with Credit Card (800) 842-3234 OR
 Mail check to: Logan University Alumni & Friends House (Checks payable to Logan University)
 1851 Schoettler Road
 Chesterfield, MO 63017

Cancellation Policy:

Cancellation of Exhibitor Booth Space received by 03/13/2023 will receive a refund less a 25% cancellation fee. Exhibitors canceling after 03/13/2023 are not eligible for a refund. All cancellation requests must be submitted to postgrad@logan.edu. Allow 2 weeks for processing of refund.

Exhibit Booth Coordinator Full Name	
Exhibit Booth Coordinator Email	
Exhibit Booth Coordinator Office Phone	
Exhibit Booth Coordinator Cell Phone	
Company Name	
Company Name to be printed on Signage	
Company Mailing Address	
Type of Products and/or Services Provided	

Please attach your company logo to the email that is created when you click on the Submit Form button below. Thank you!